

QUANTUM QC3W

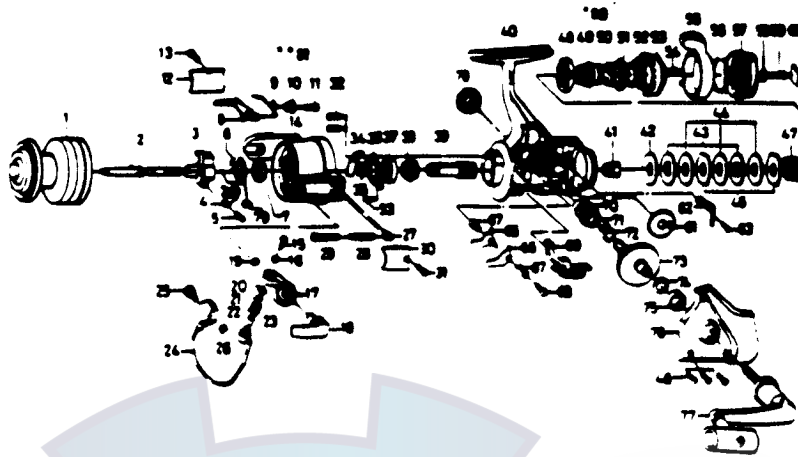

KEY PART NO. NO.	DESCRIPTION	PRICE	KEY PART NO. NO.	DESCRIPTION	PRICE
1 GK321	SPOOL (EXTRA)	6.31	43 MT041	EARED WASHER	1.83
2 MT315	SPOOL (MIN)	6.88	44 MT046	DRAG WASHER C	1.83
3 MT025	MAIN SHAFT	3.16	45 MT030	KEY WASHER	1.83
4 MT083	OSCILLATING SLIDER	1.83	46 MT057	SIDE COVER SCREW	2.87
5 MT161	OSC. SLIDER RETAINER	.85	47 MT031	DRAG COIL SPRING	1.27
6 MT088	OSC. SLIDER SCREW	.85	48 MT112	DRAG NUT A	3.39
7 MT006	ROTOR NUT LOCK WASHER	1.27	49 MT121	DRAG SCREW	1.43
8 GK019	ROTOR NUT	1.27	50 MT106	DRAG SCREW WASHER A	.98
9 MT049	BAIL TRIP LEVER	1.71	51 MT110	DRAG HOLDER	1.83
10 MT137	BAIL TRIP LEVER SPRING	.85	52 MT112	DRAG NUT A	3.39
11 MT037	BAIL TRIP LV. BUSHING	.98	53 MT117	DRAG NUT B	4.53
12 MT024	BAIL TRIP LEVER SCREW	.85	54 MT118	DRAG SPRING	1.09
13 MT085	BAIL TRIP COVER	1.09	55 MT094	POWER LEVER	4.53
14 GK009	BAIL SPG COVER SCRW	1.09	56 MT095	POWER LEVER RETAINER	.46
15 MT108	ROTOR	4.87	57 MT032	DRAG KNOB	3.39
16 MT102	BAIL SCREW	1.27	58 MT119	DRAG KNOB WASHER	.85
17 MT007	LOCK WASHER	.46	59 MT079	DRAG KNOB SCREW	.85
18 MT115	BAIL ARM	1.66	60 MT120	DRAG KNOB NAME PLATE	1.27
19 GK002	CAN CAST LEVER	5.68	61 MT053	OSCILLATING GEAR	1.43
20 MT017	CAN CAST LEVER RET.	.46	62 MT068	CLICK LEAF SPRING	.98
21 MT015	LINE ROLLER COLLAR	.46	63 MT067	CLICK LEAF SPRING SCRW	.85
22 MT004	LINE ROLLER	.46	64 MT014	ANTI-REV. PANTL COLLAR	.98
23 MT016	LINE ROLLER BUSHING	1.72	65 MT063	ANTI-REV. PANTL A	1.09
24 MT347	BAIL	.46	66 MT064	ANTI-REV. PANTL B	1.27
25 MT044	BAIL HOLDER PIN	3.73	67 MT061	ANTI-REV. PANTL SPG A	.85
26 MT003	BAIL TRIP CAN RET.	1.83	68 MT089	ANTI-REV. PANTL SCREW	.85
27 MT020	BAIL SPG SHAFT HLDER	.85	69 MT059	ANTI-REV. LEVER	1.27
28 MT022	BAIL SPRING	.98	70 MT052	BUSHING	2.24
29 MT029	BAIL SPRING SHAFT	.46	71 MT253	OSCILLATING PW GEAR	1.66
30 MT087	BAIL SPRING COVER	1.09	72 MT086	ANTI-REV. PANTL SPG B	.98
31 MT065	BAIL SPG COVER SCRW	1.09	73 MT012	DRIVE GEAR	10.26
32 MT080	BEARING RET. SCREW A	.98	74 MT026	DRIVE GEAR WASHER	.46
33 MT093	BEARING RET. SCREW B	.98	75 MT157	BALL BEARING	9.12
34 MT082	BAIL TRIP PLATE	.98	76 MT323	SIDE COVER	5.68
35 MT027	PINION WASHER	1.43	77 MT318	HANDLE ASST.	10.26
36 MT040	BEARING RETAINER	.85	78 MT073	HANDLE SCREW CAP	2.30
37 MT028	BALL BEARING	1.72	79 MT058	RTR NUT LOCK SCREW	.85
38 MT060	ANTI-REV. RATCHET	9.12	*80 MT121	DRAG SCREW	1.43
39 MT011	PINION GEAR	3.33	**81 MT122	BAIL TRIP LEVER WSR	.46
40 MT301	BODY	6.59			
41 MT066	CLICK GEAR	9.12			
42 MT039	DRAG WASHER B	1.83			
		1.66			

*Not pictured
Located between keys 49 & 80

**Not pictured
Located between keys 10 & 11

Prices subject to change without notice. Prices do not include postage and handling.

PLEASE ORDER BY PART NUMBER

Rev. 11/90

Zebco Division Brunswick Corporation, Box 278, Tulsa, OK 74101 USA 918-688-6881

